

Quality Color
Style Design
Functionality
Quality Color
Style Design
Functionality
Quality Color
Style Design
Functionality

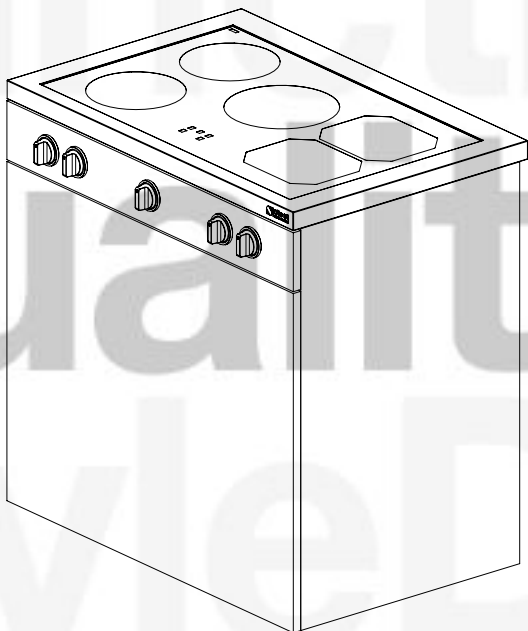

steel

stile in cucina

Control panel setting

1

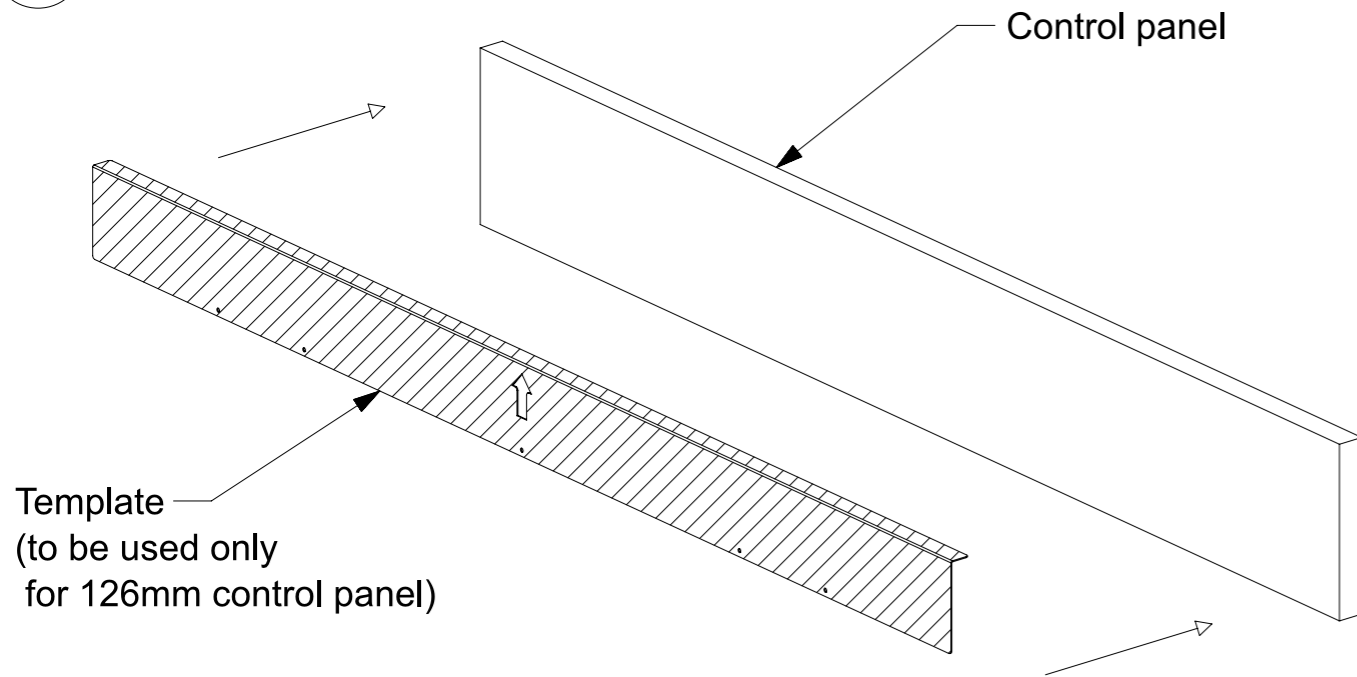

1.1

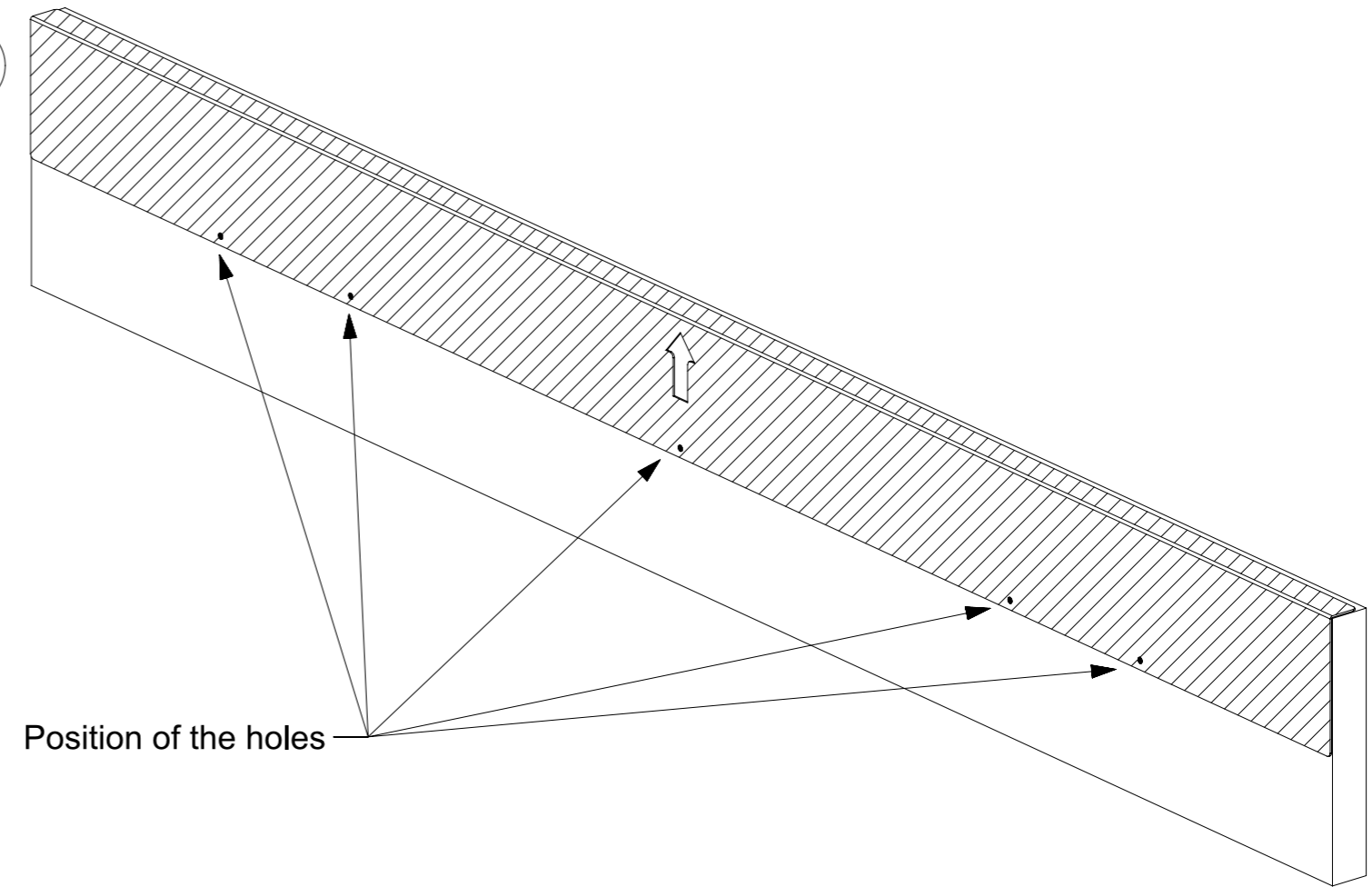

1.2

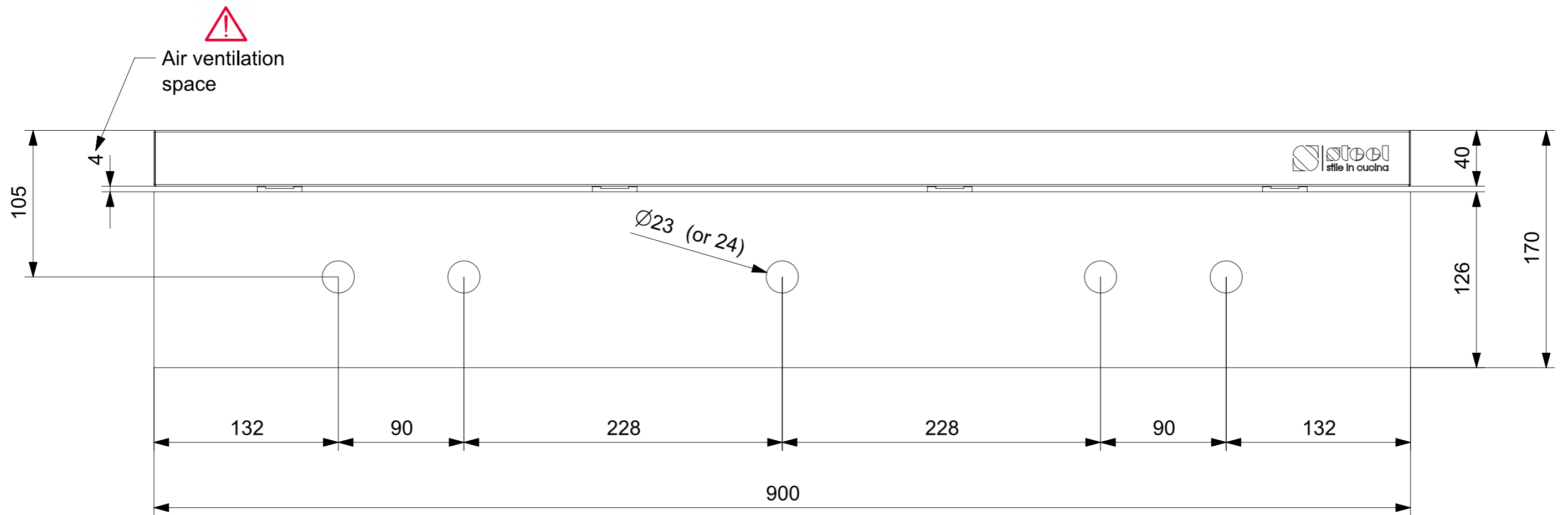

Control panel setting

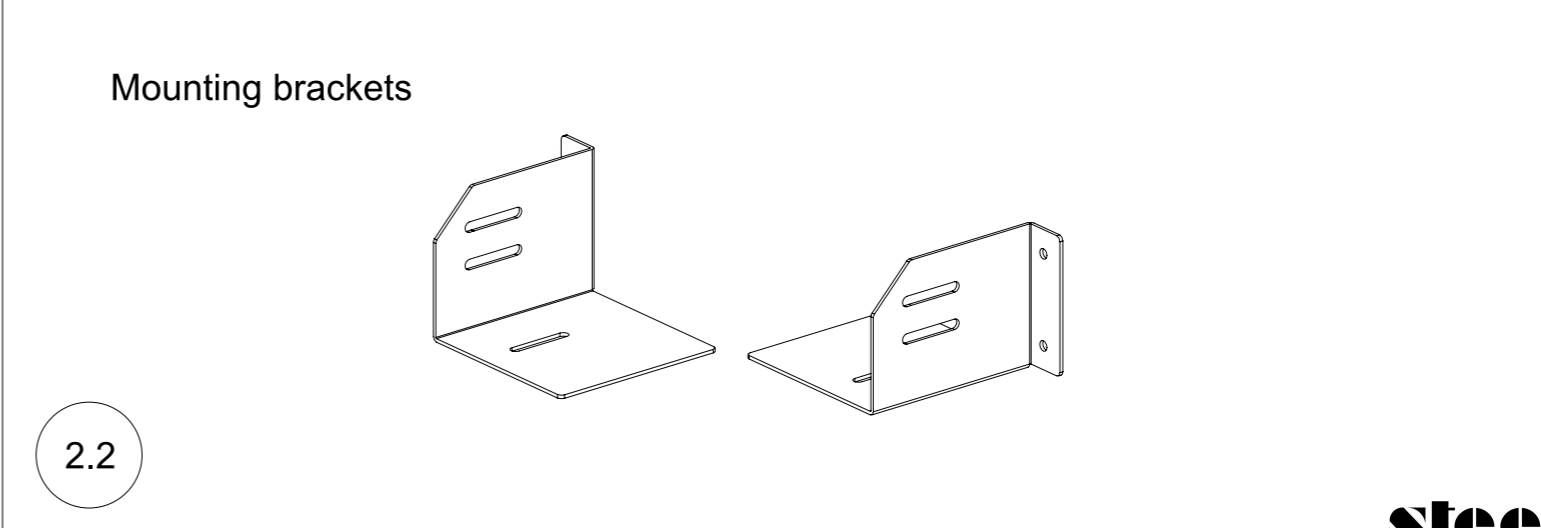
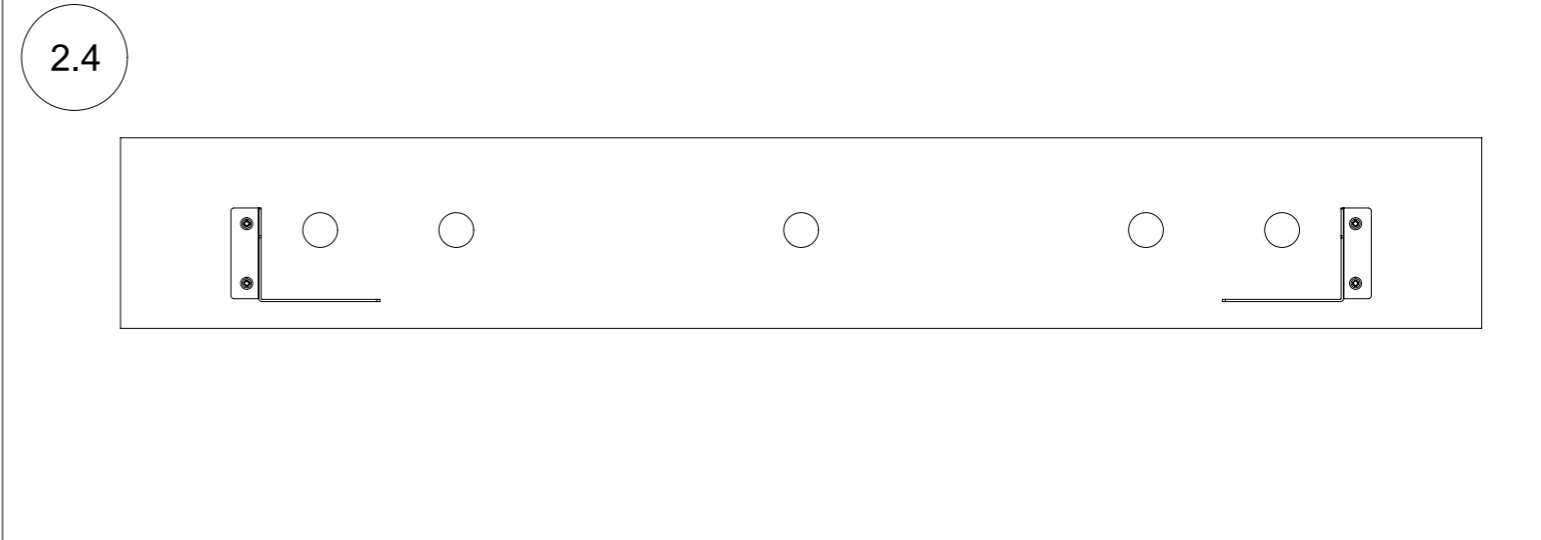
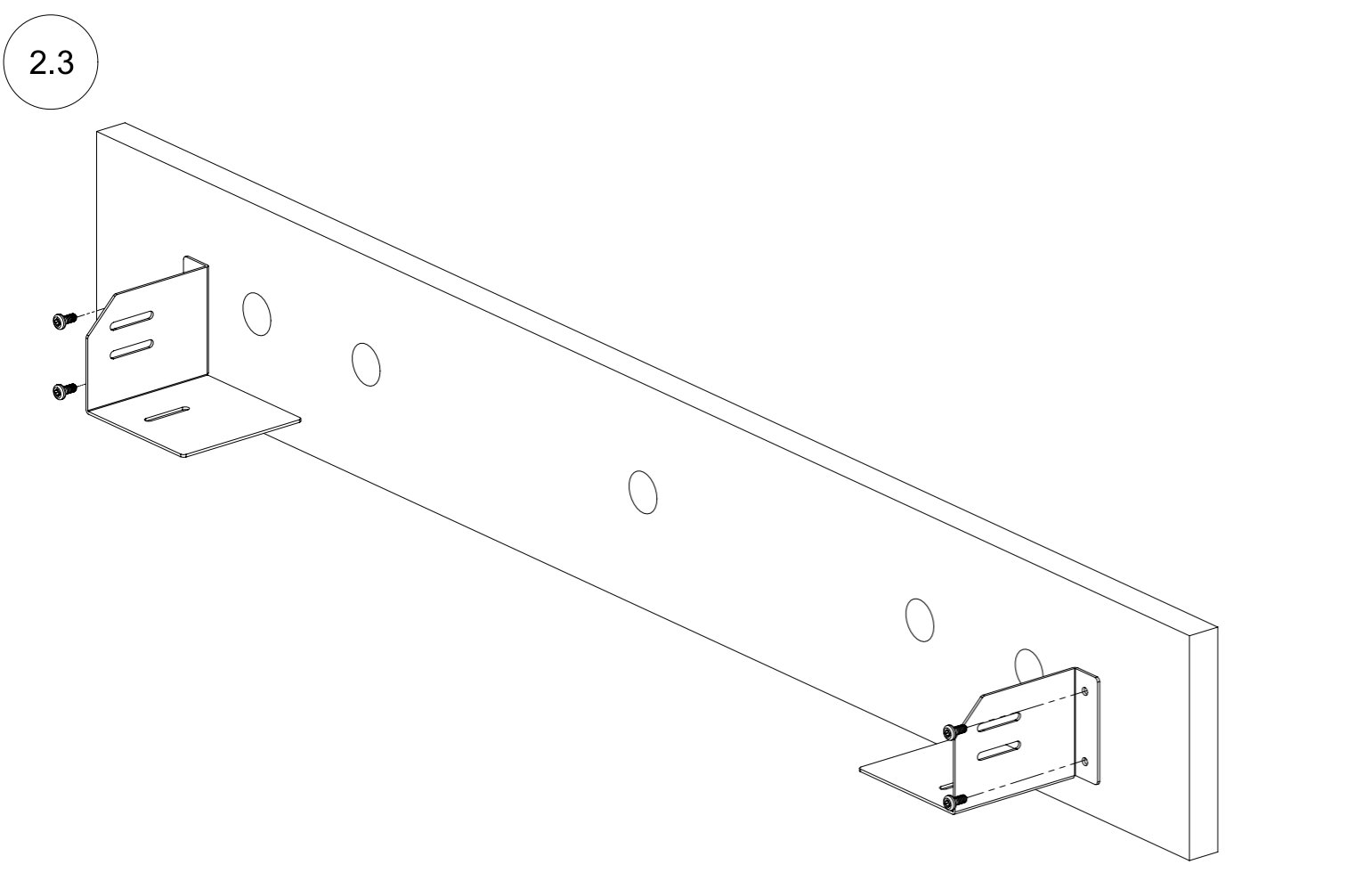
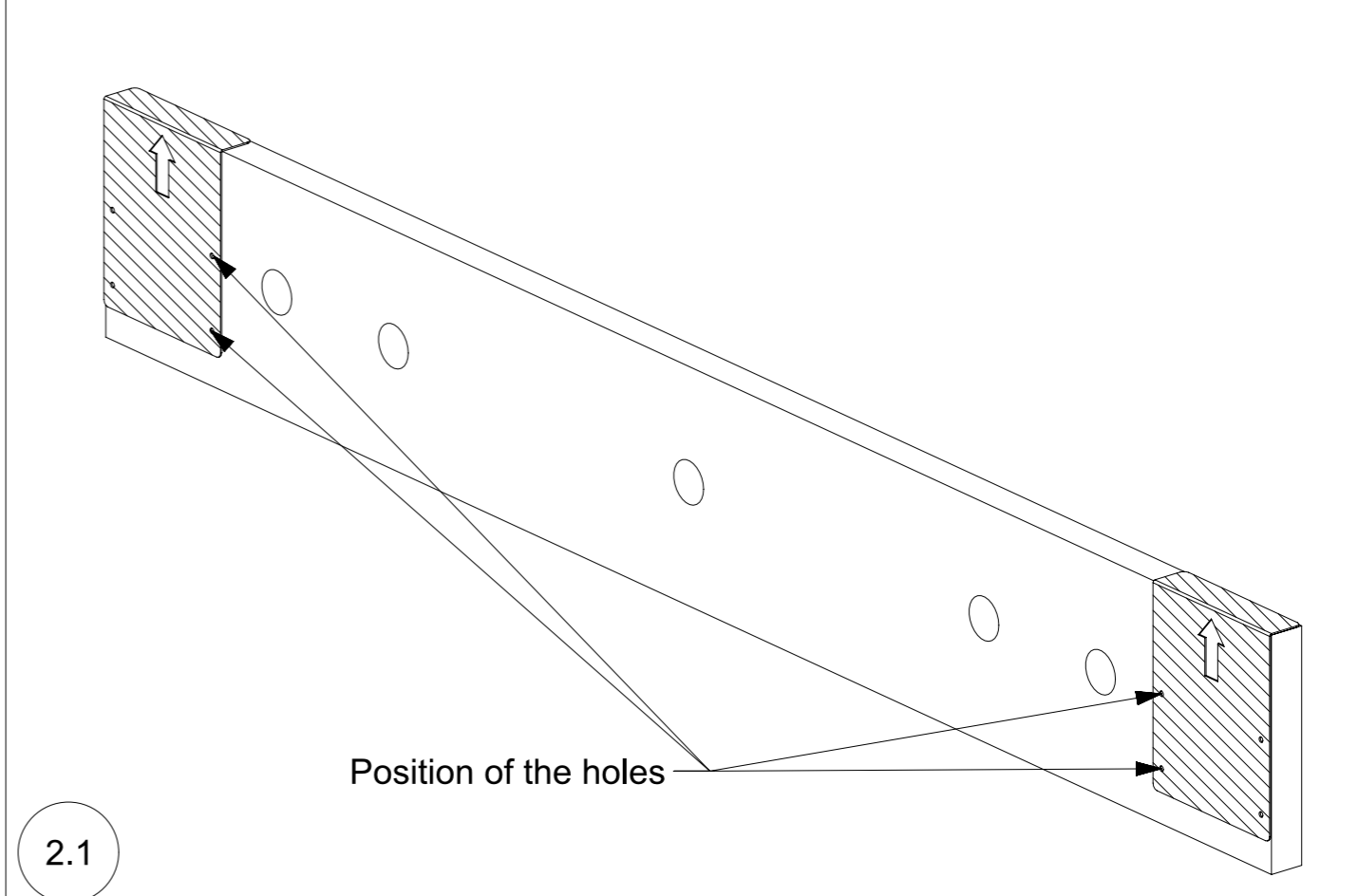
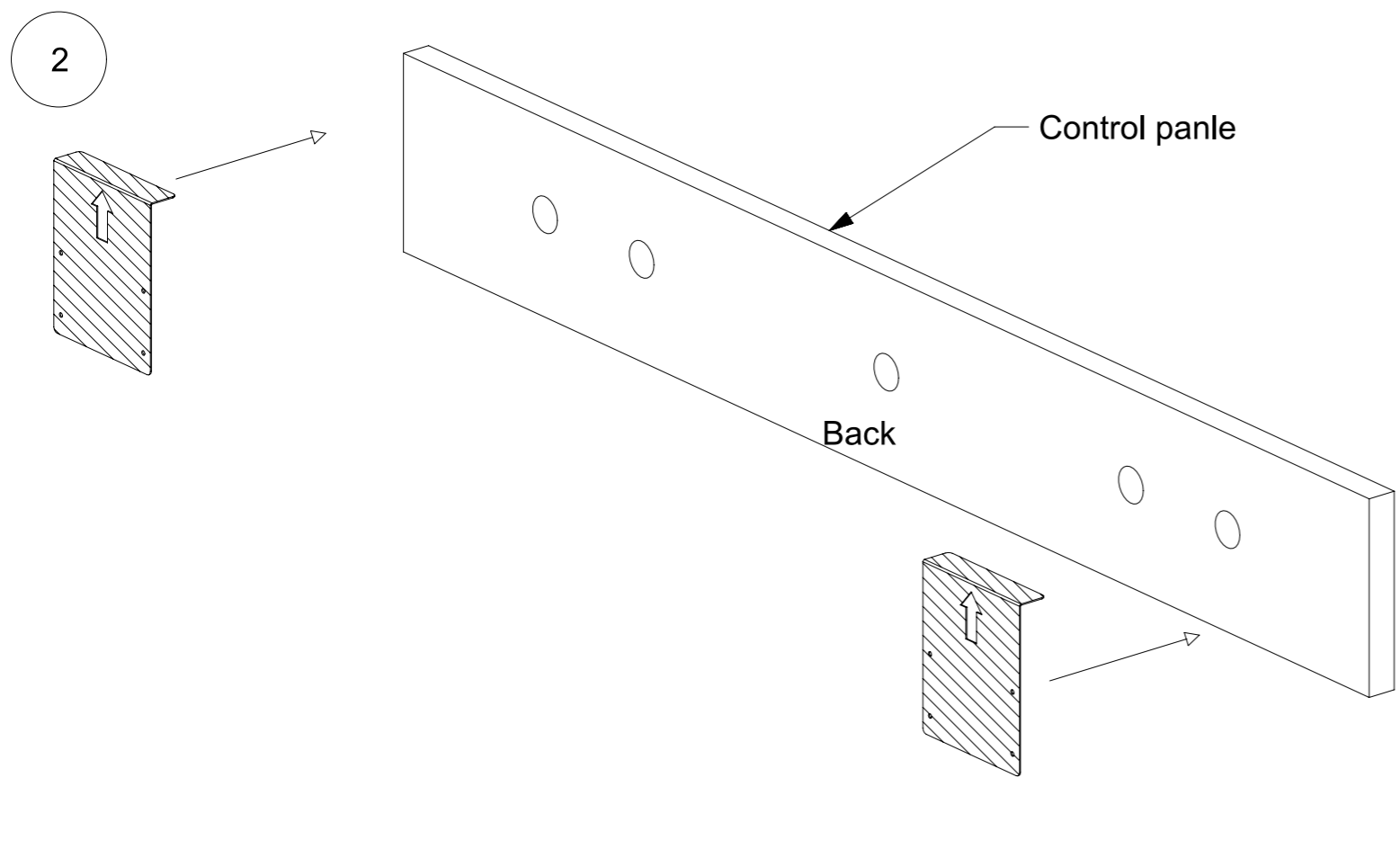

Electronic unit installation

3

Insert electronic unit
between the brackets

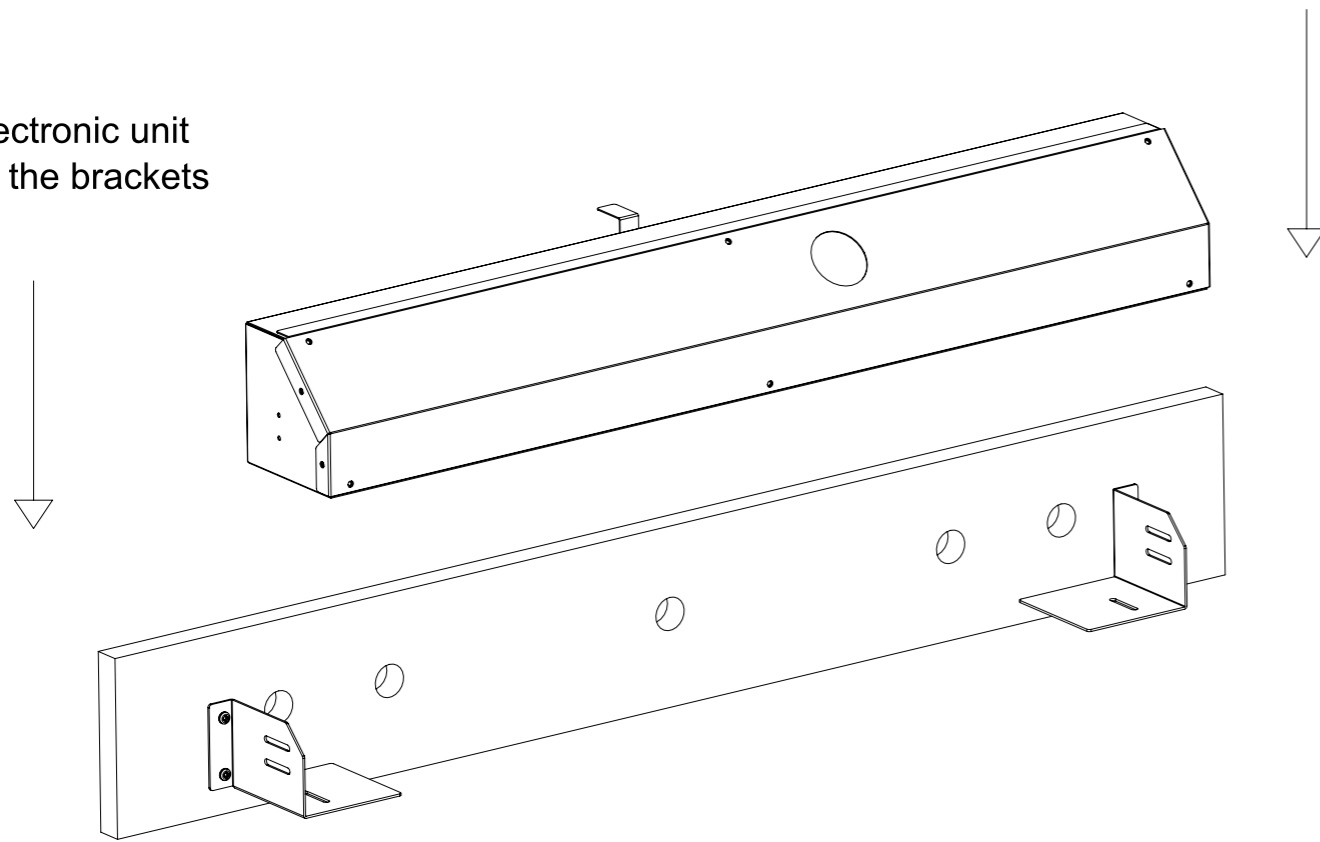

3.1

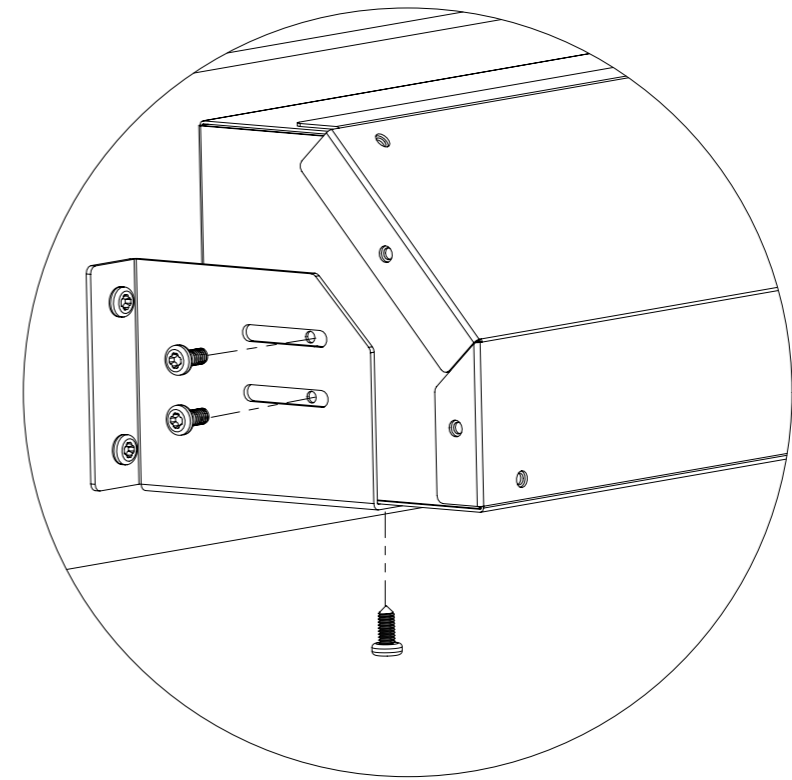

3.2

use buttonholes
for correct fixing

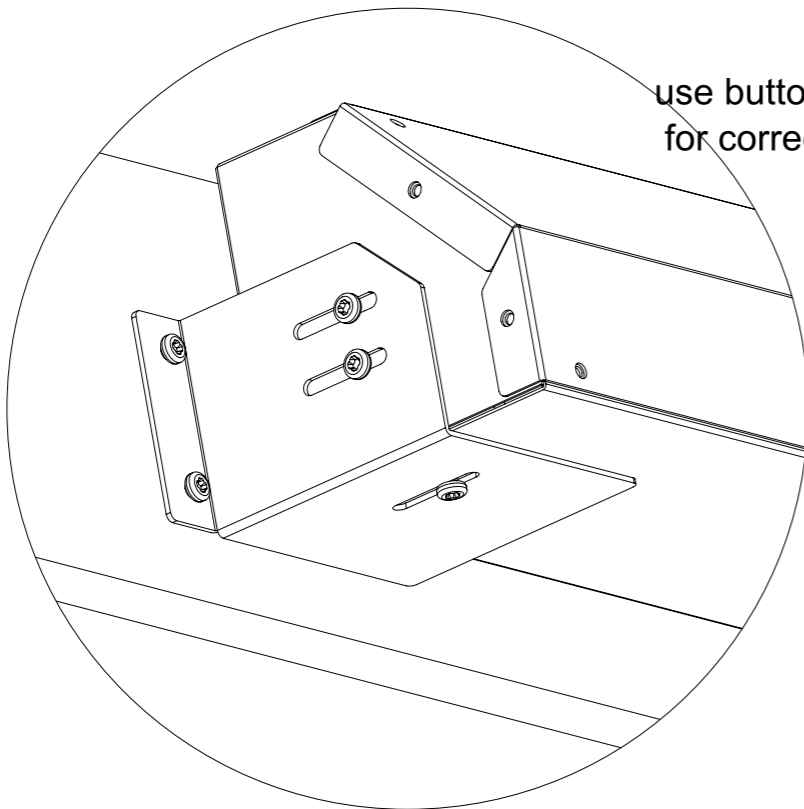

3.4

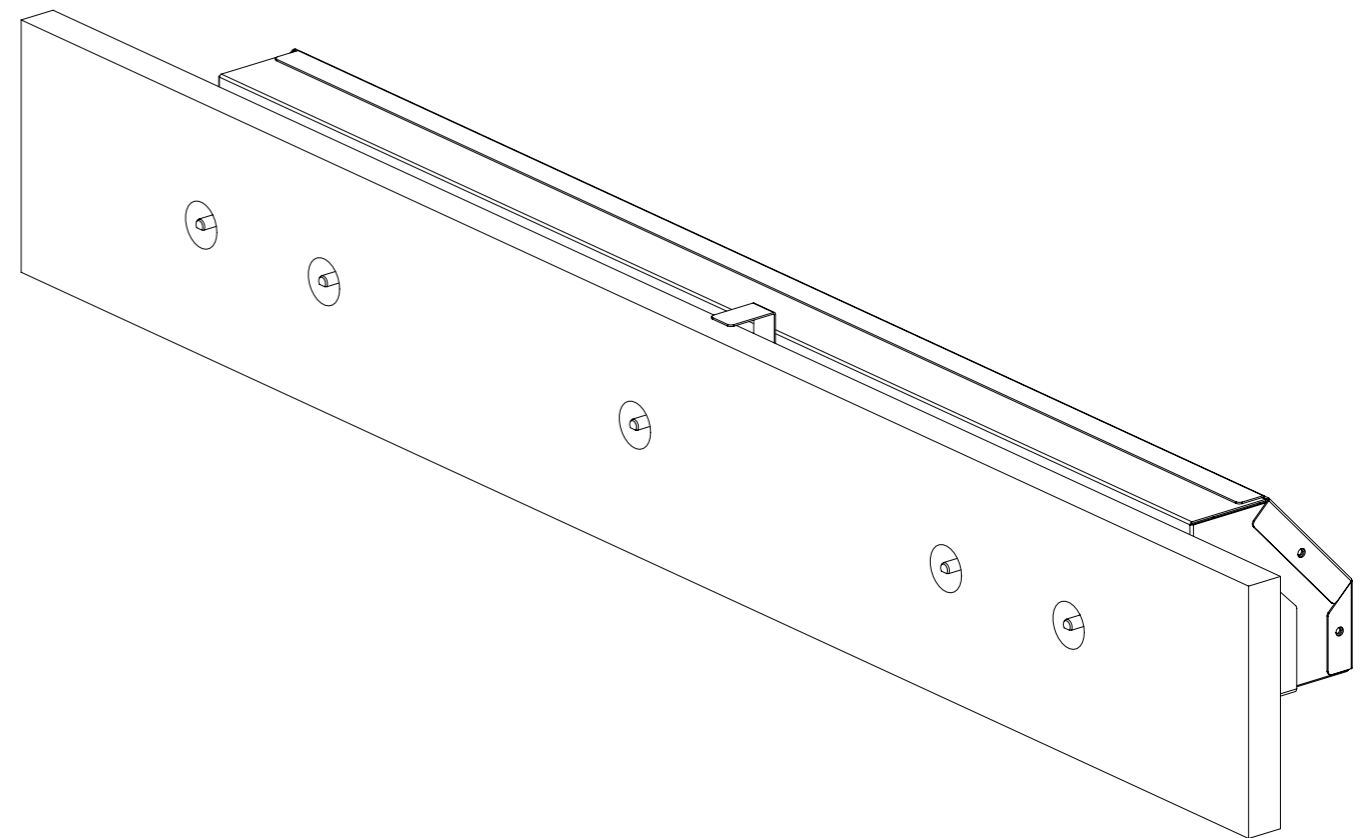

Cabinet screw holes setting by using the template

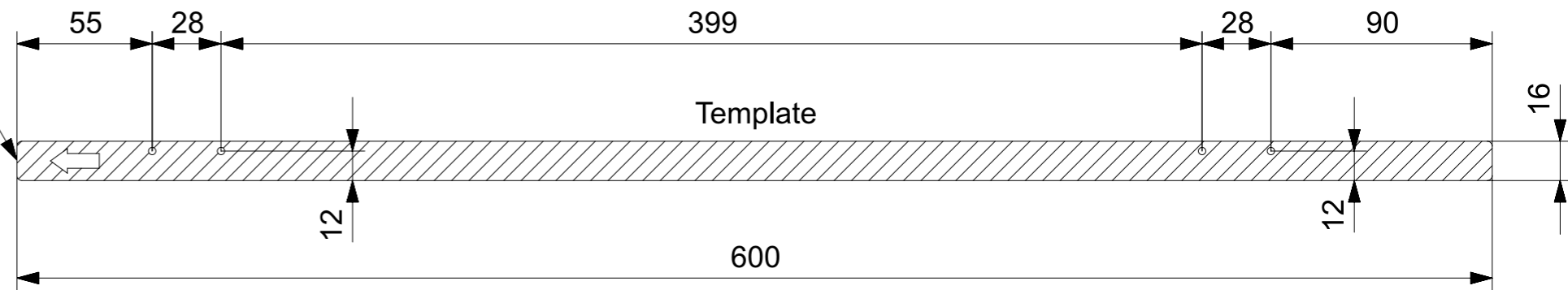
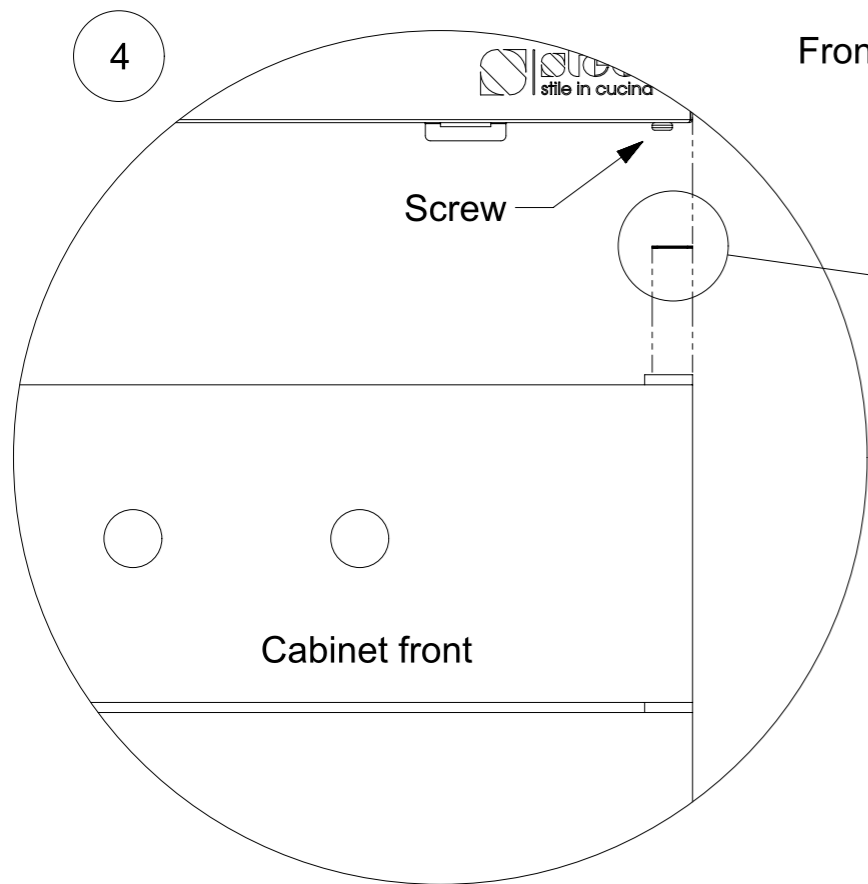

Important:
for the left side holes,
turn the template upside down
because of the asymmetrical
position of the screws

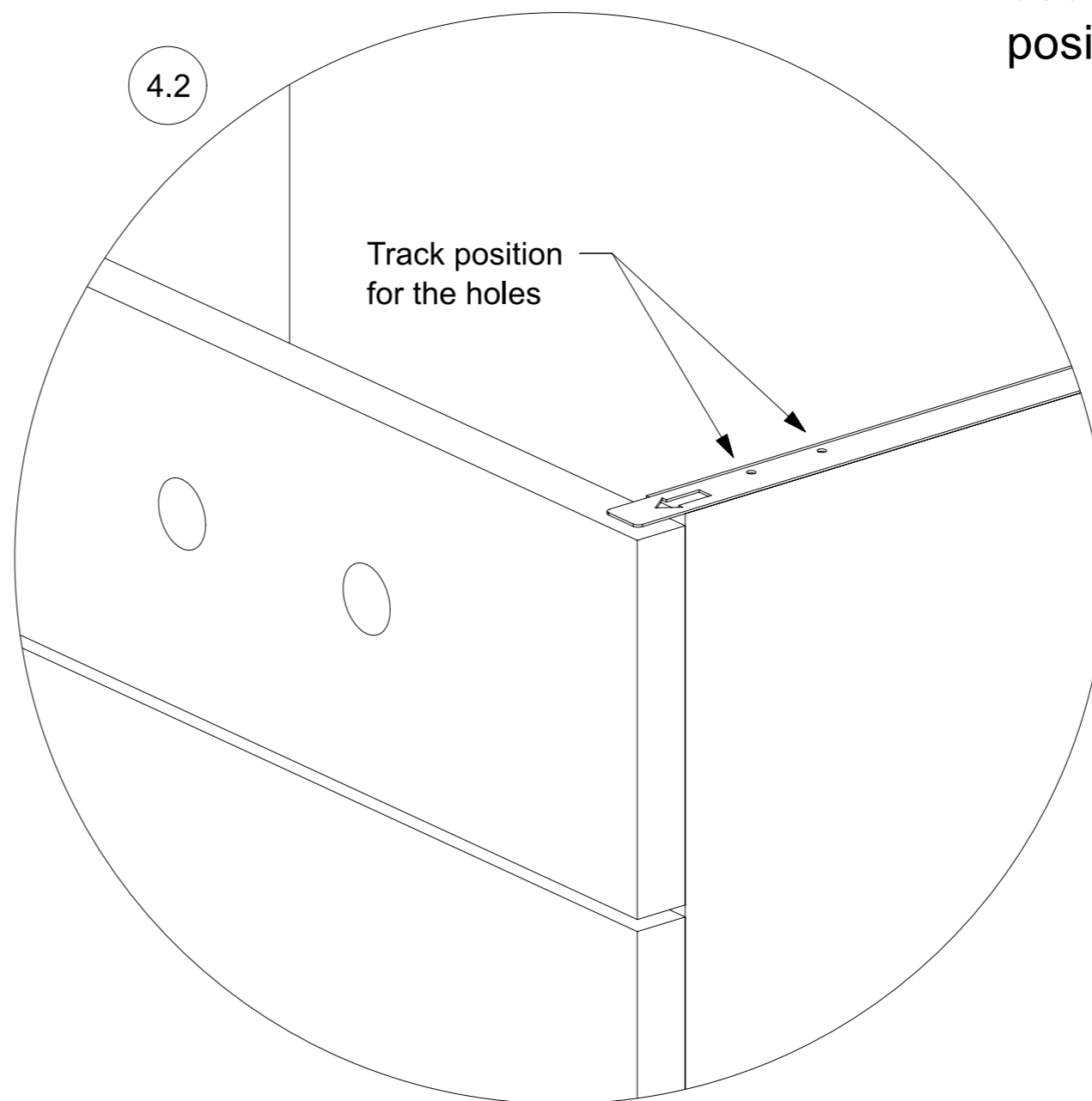
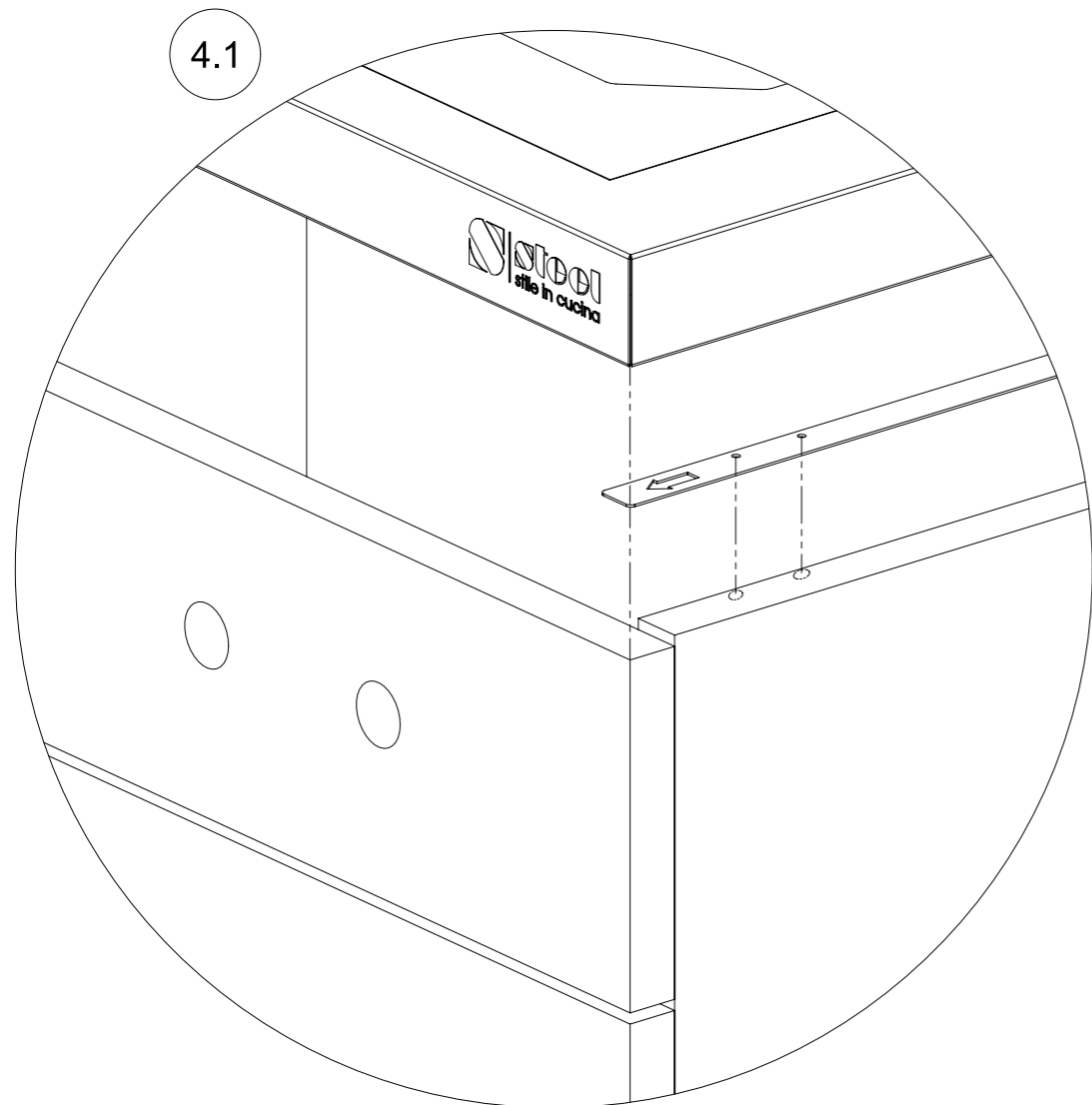

Important:
the final holes
in the cabinet must be $\varnothing 10\text{mm}$

Cabinet screw holes setting without template

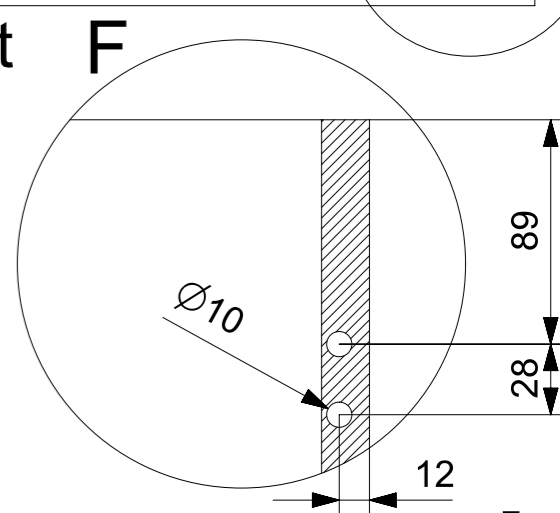
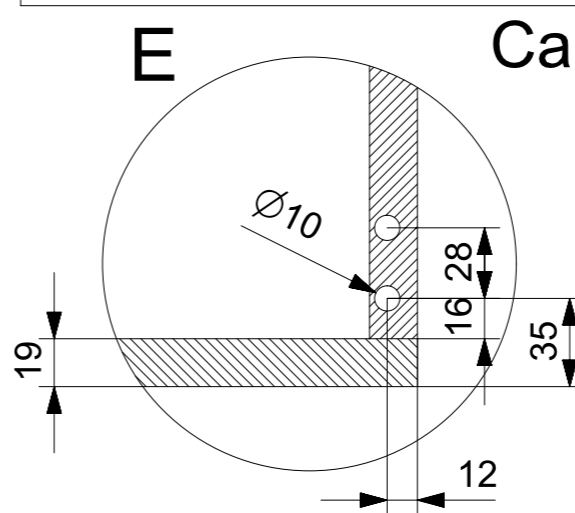
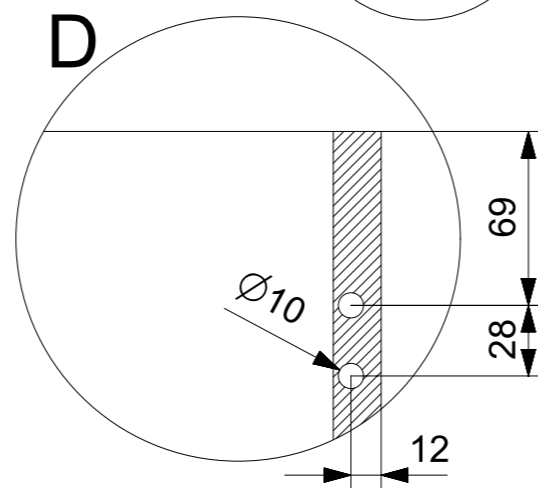
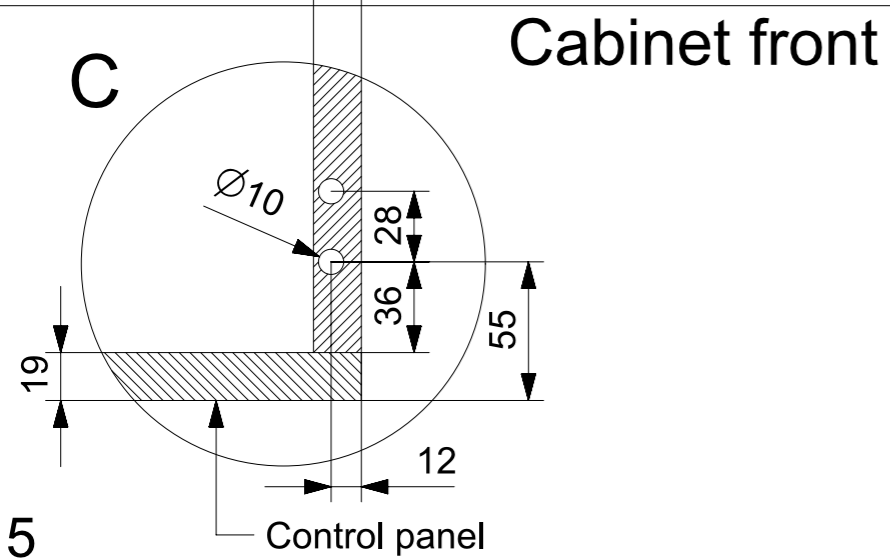
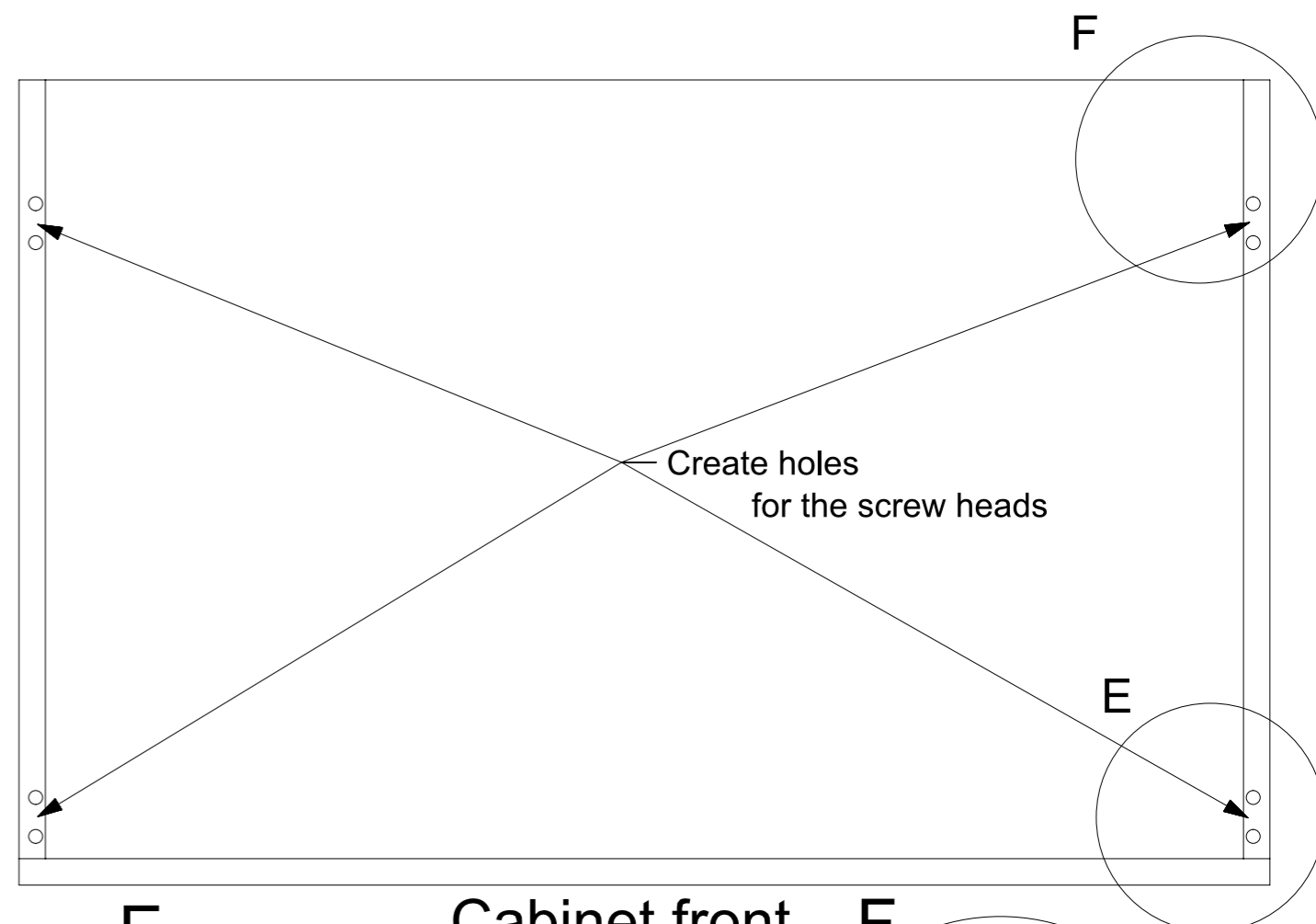
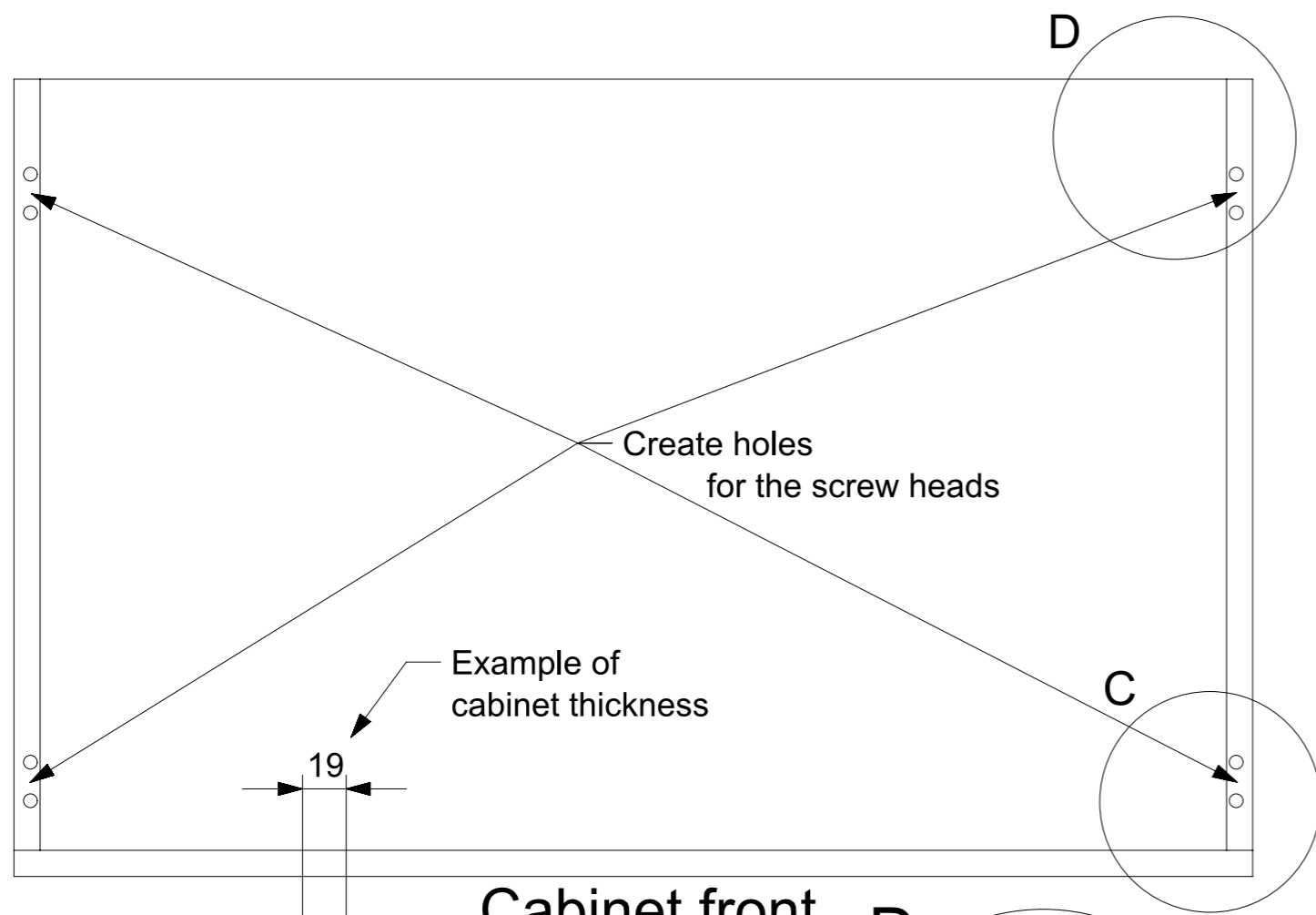
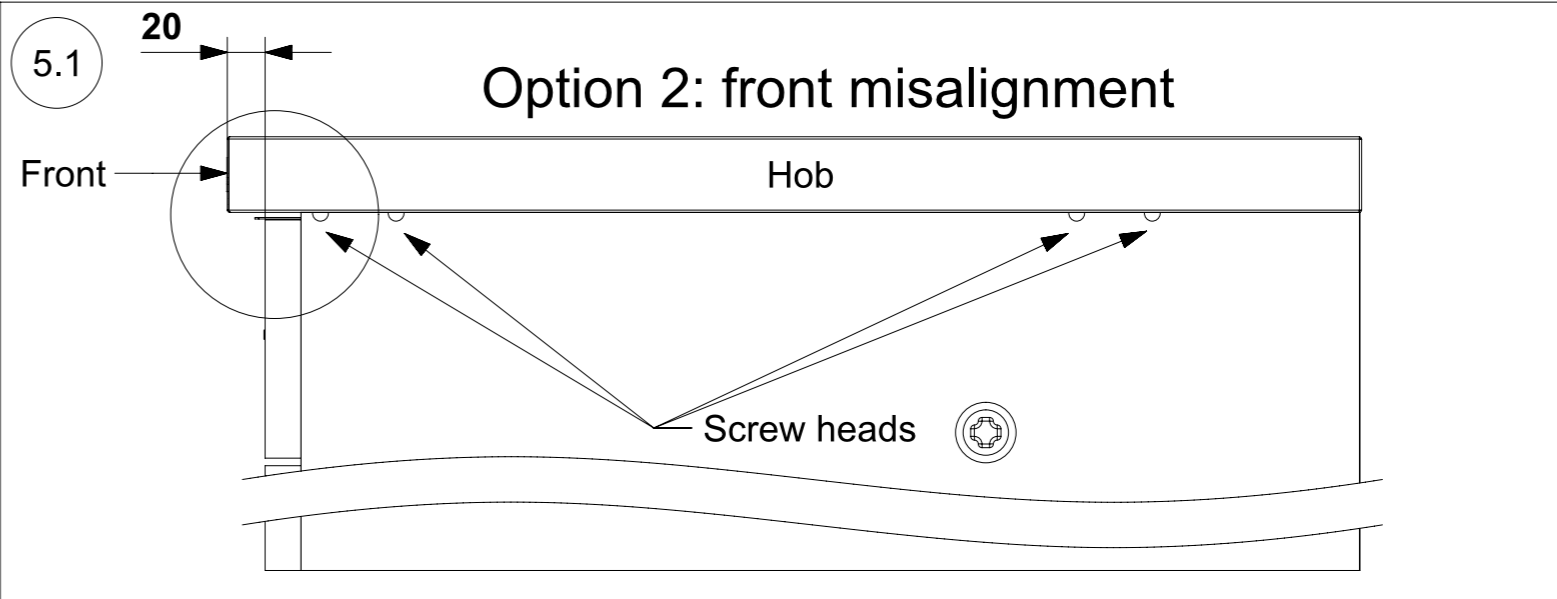
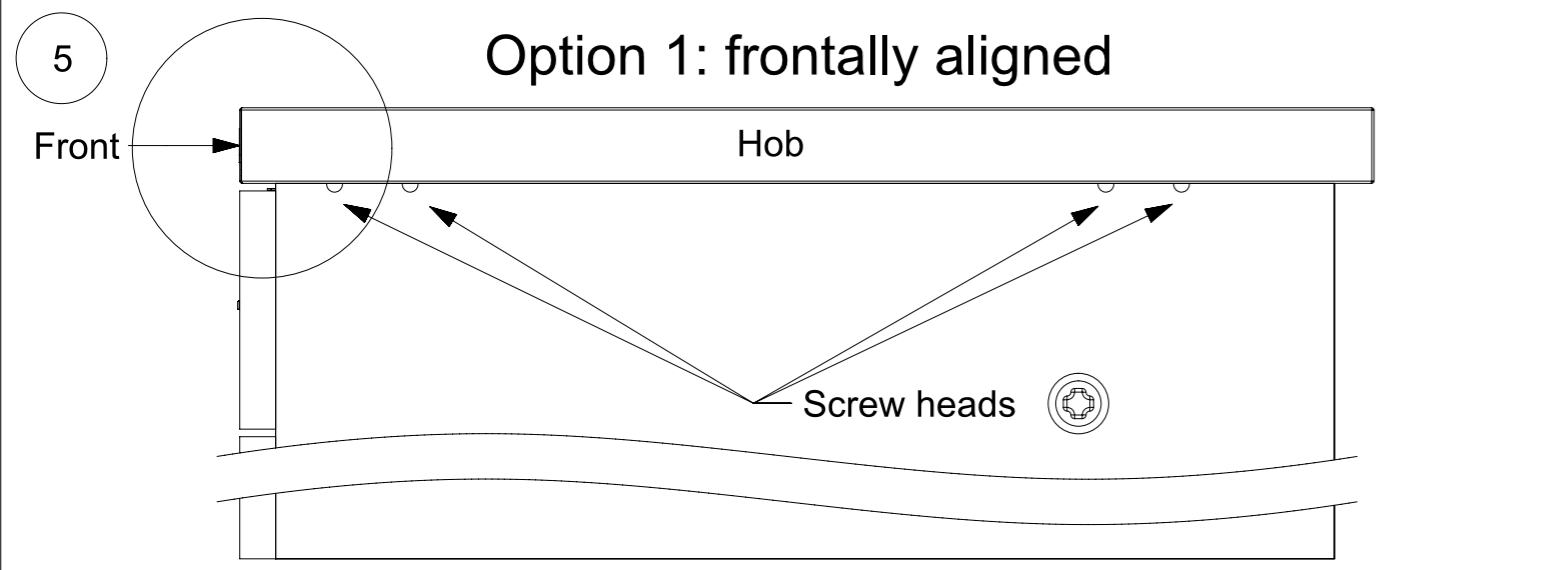

Hob installation

6

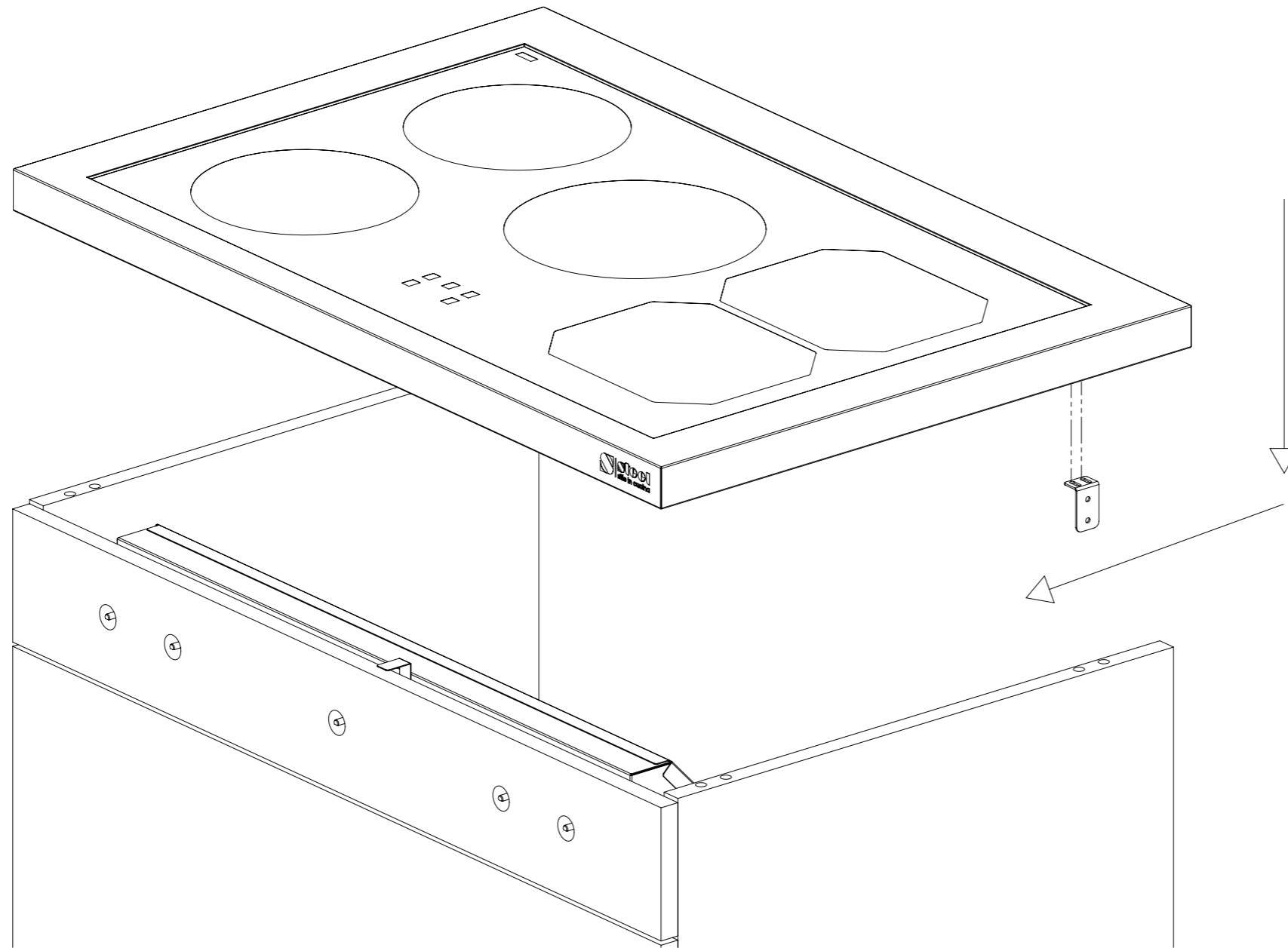

6.3

Mounting brackets

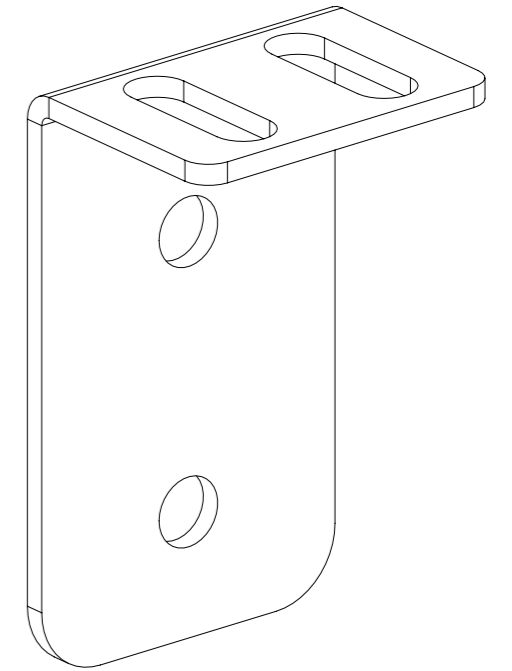

X2

6.1

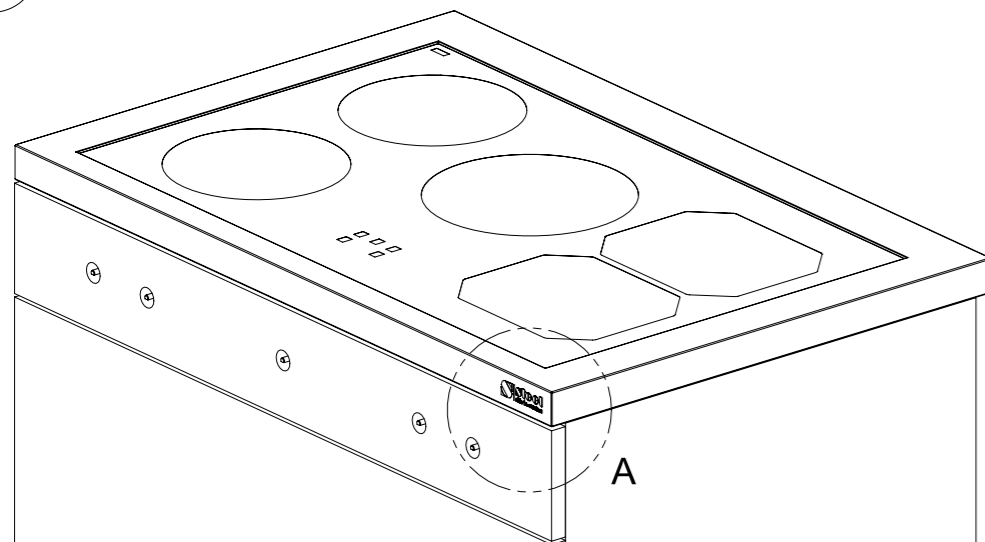

6.2

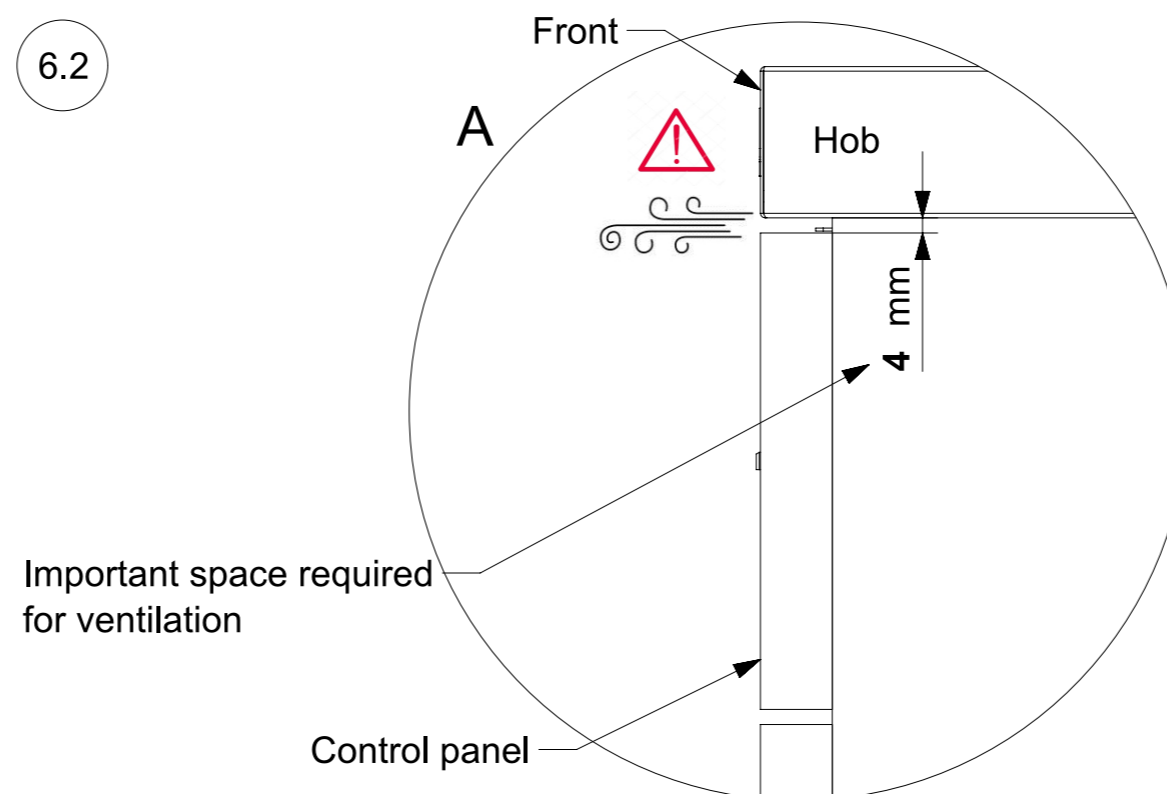

6.4

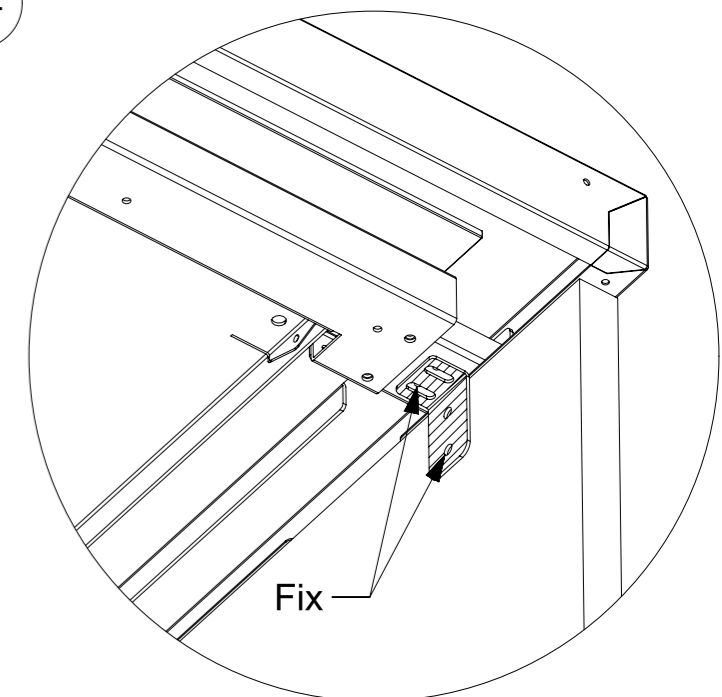

Bezel installation optional

7

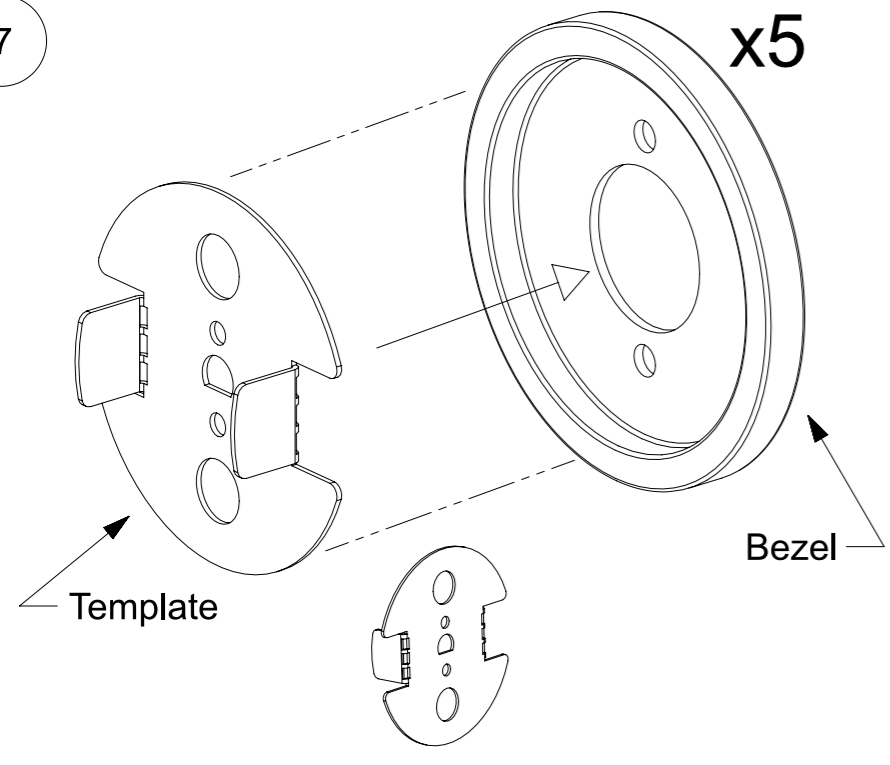

7.1

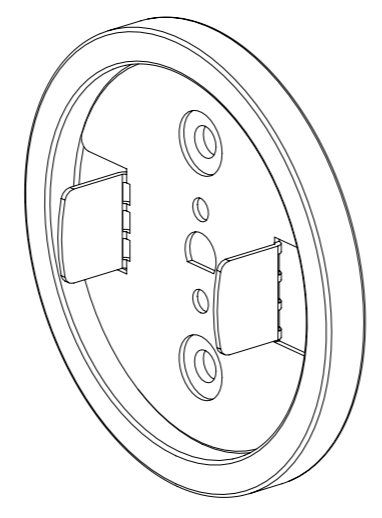

7.2

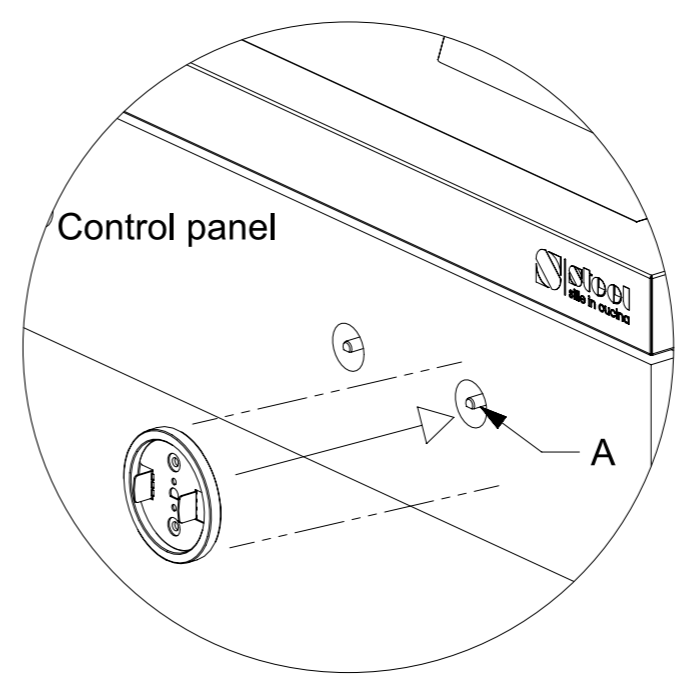

7.3

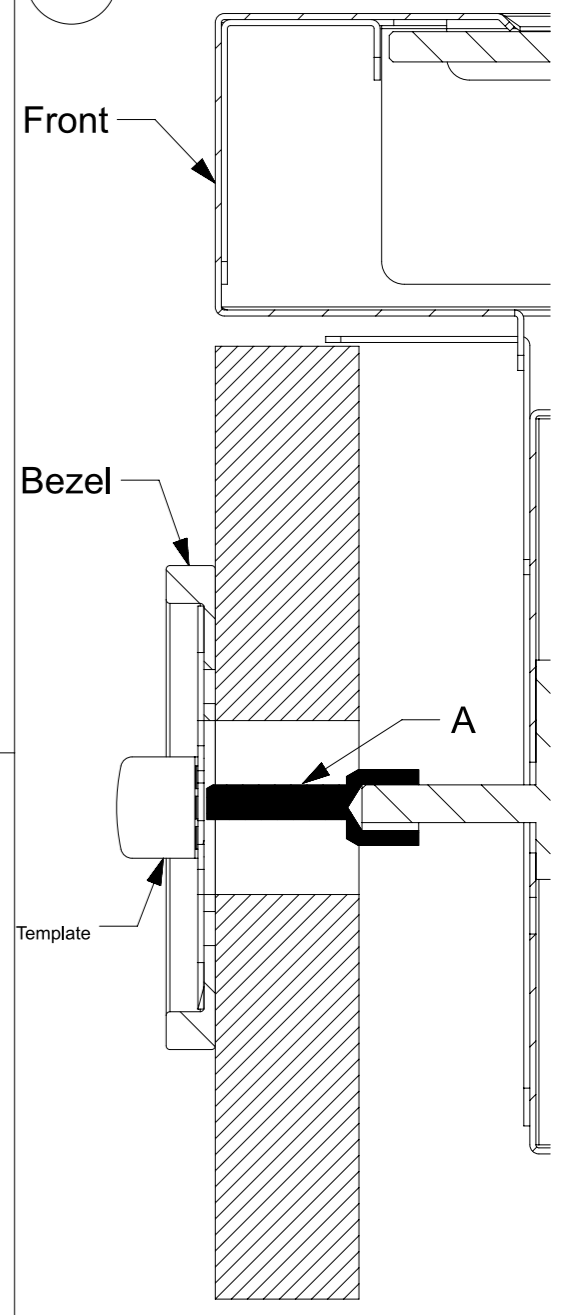

7.4

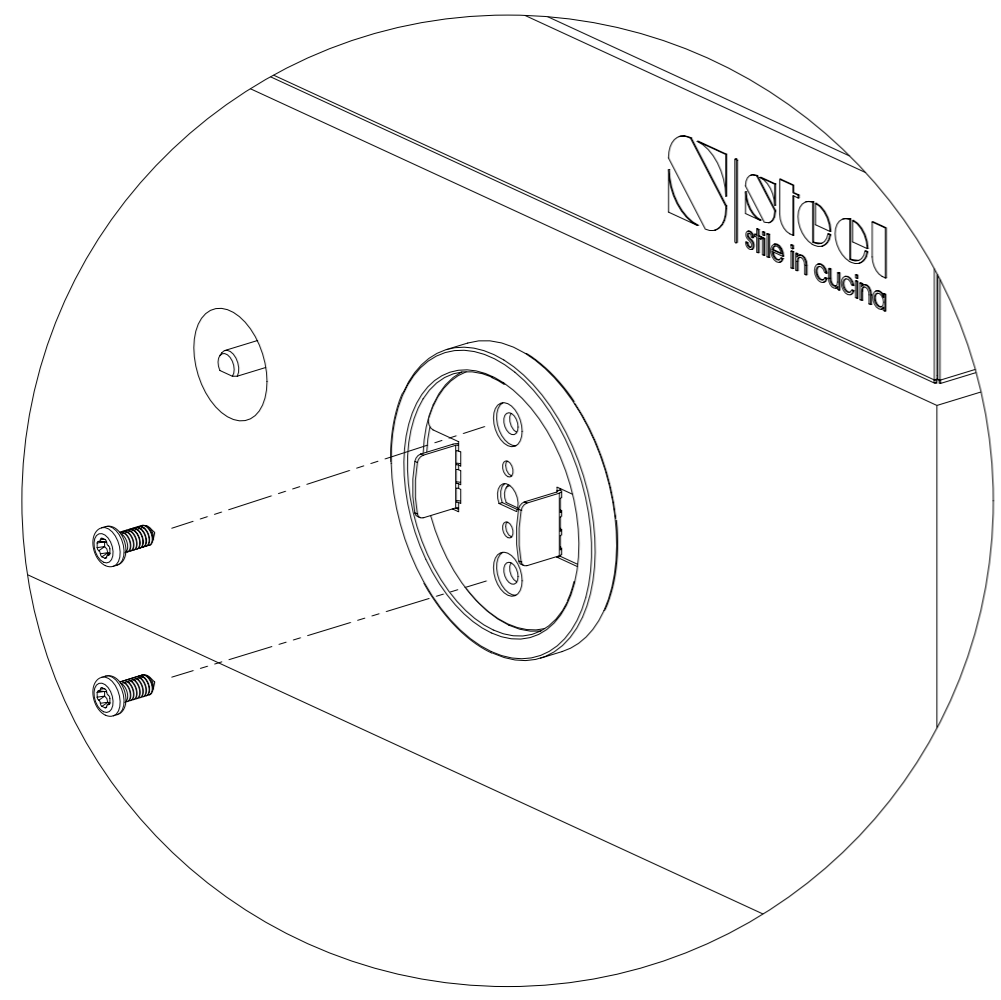

Fix the bezel

7.5

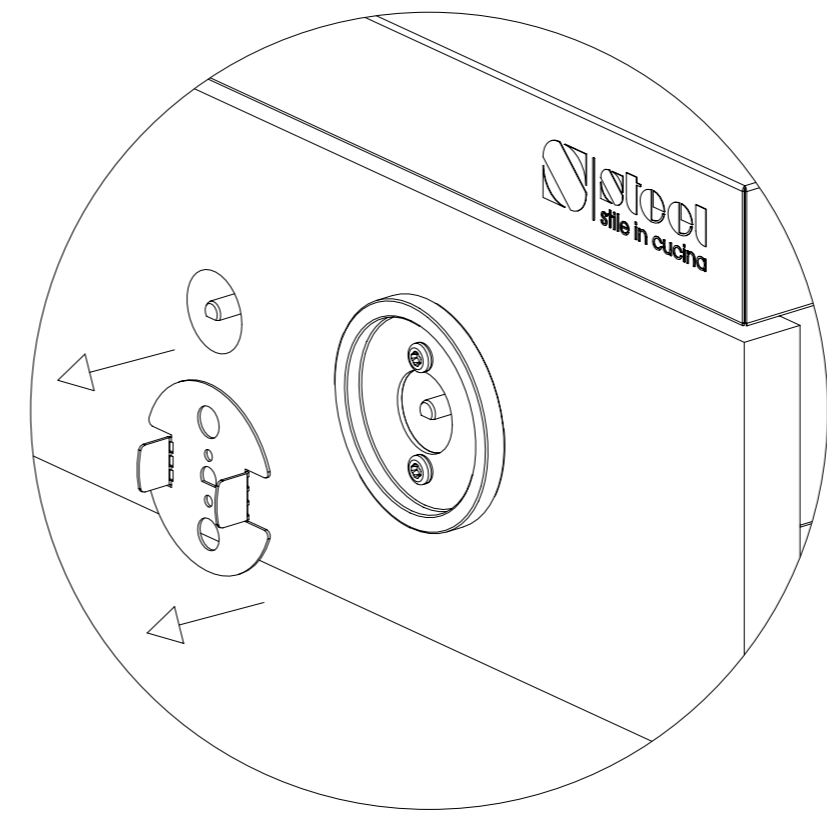

Remove the template

Knob installation optional

8

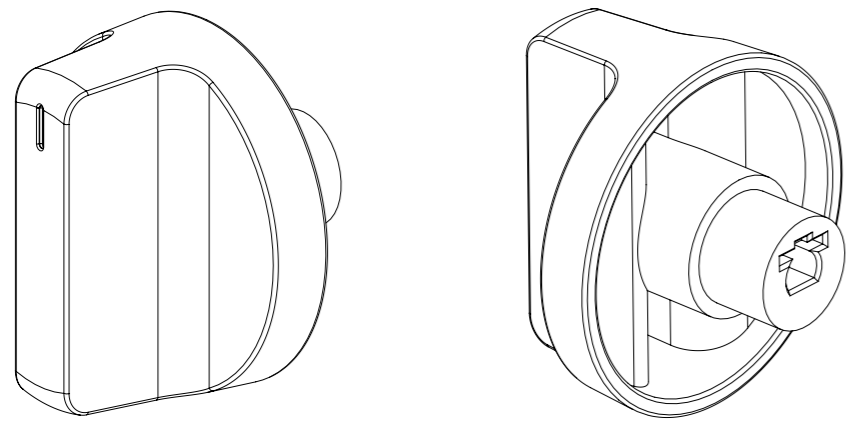

x5

8.1

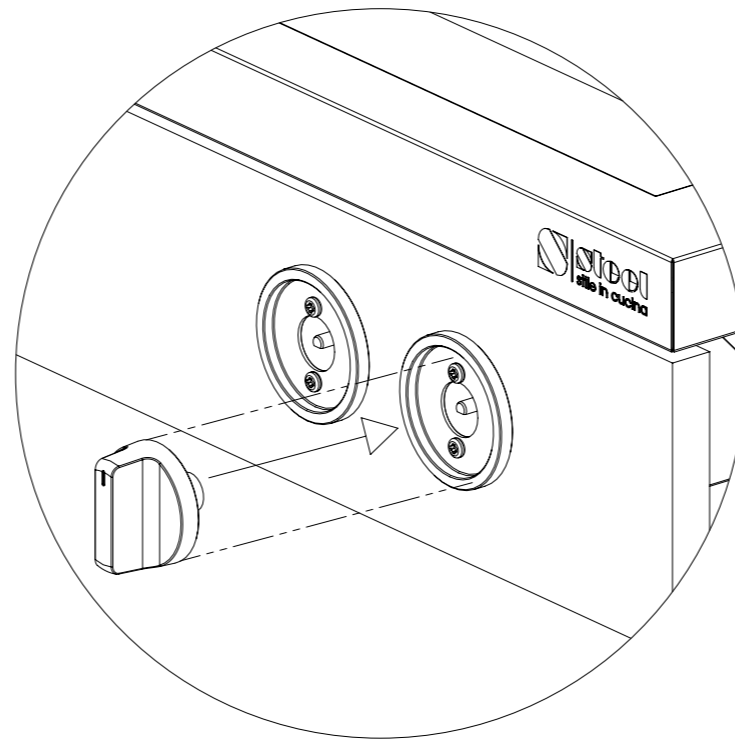

8.2

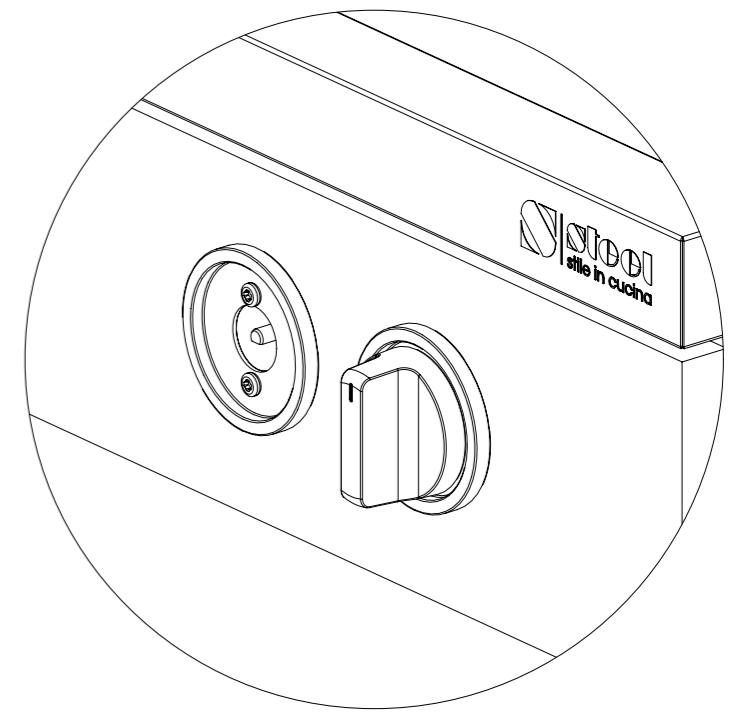

8.3

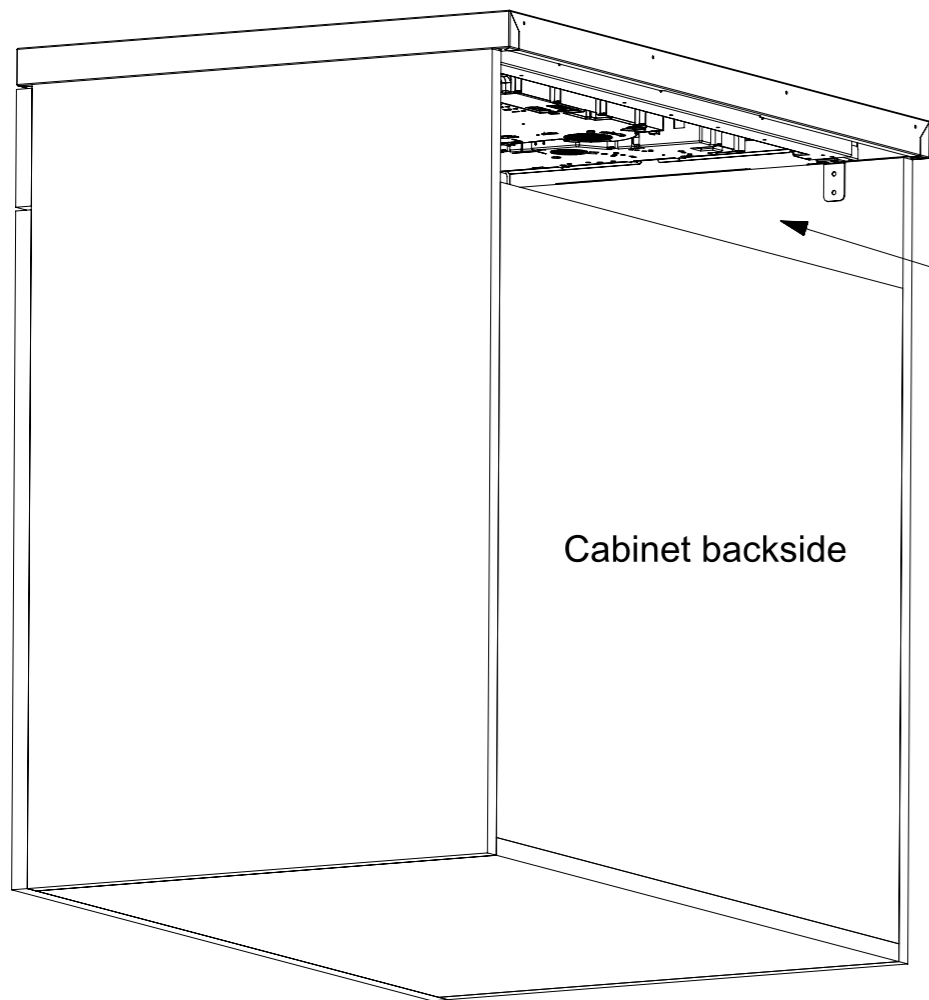

Cabinet backside

Create a passage for the ventilation
(minimum 10 cm)

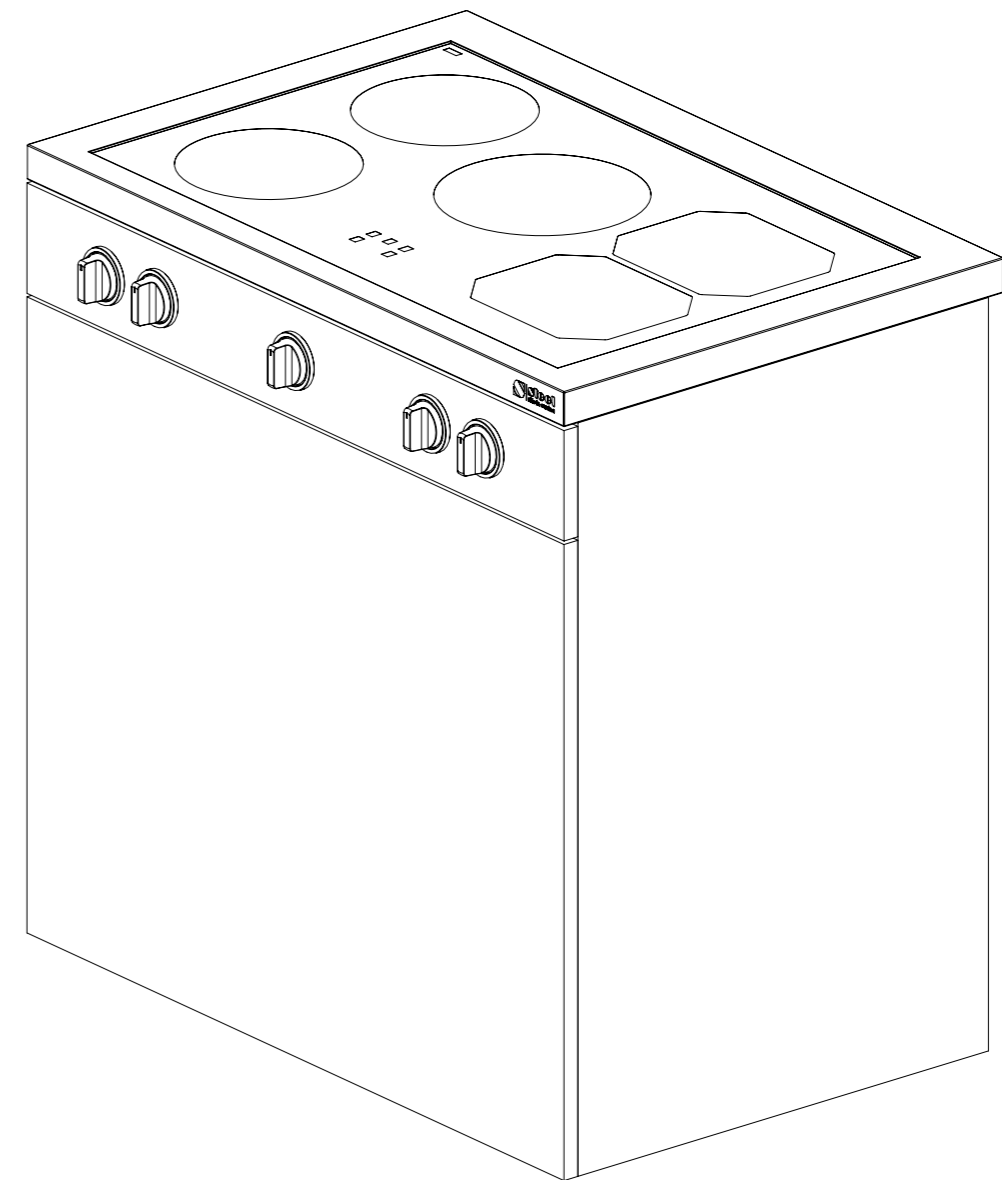

9

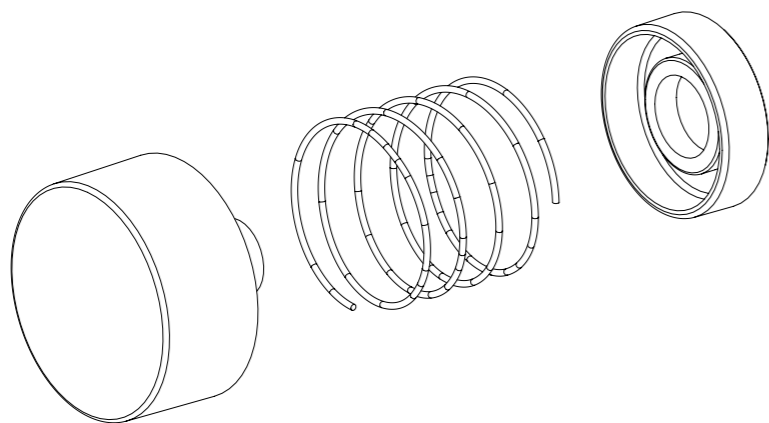

9.1

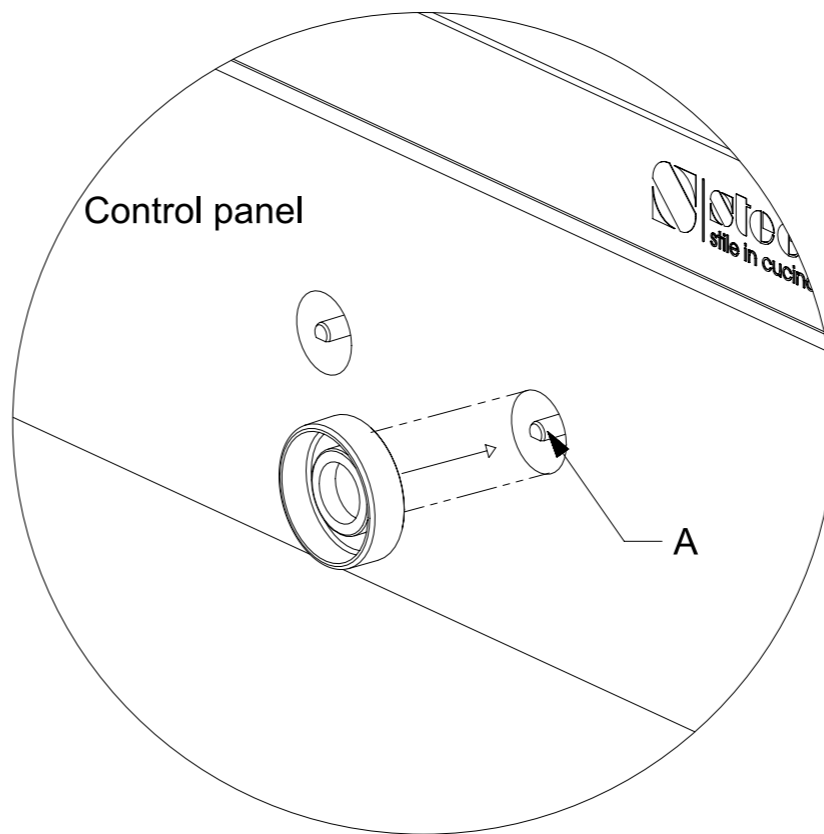

9.2

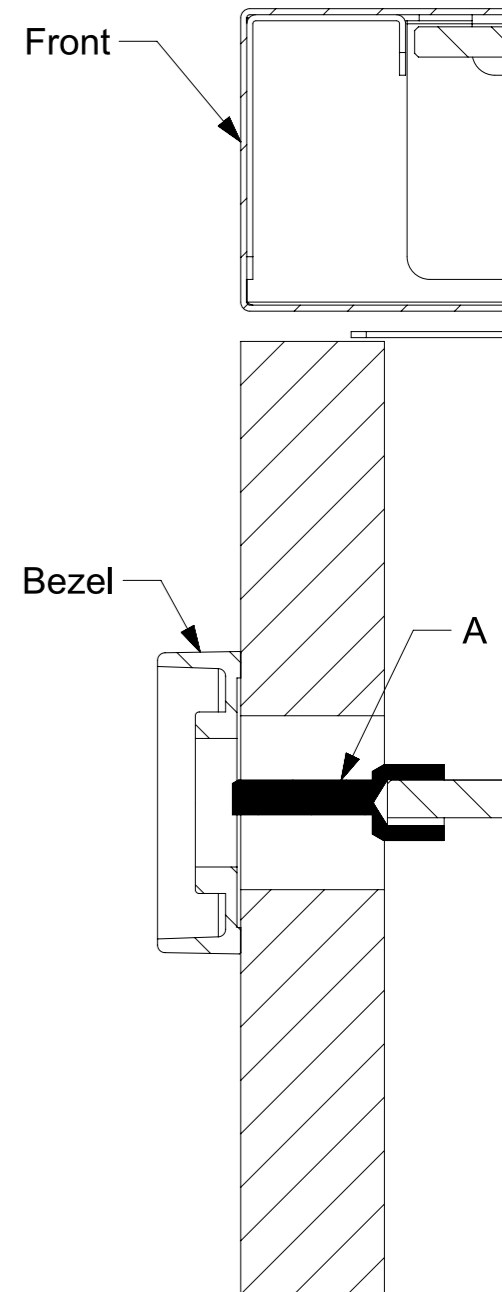

9.3

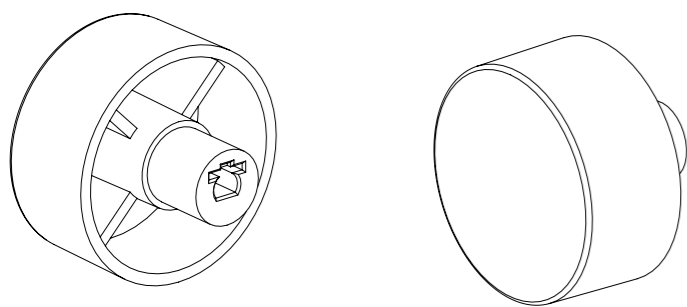

X5

9.4

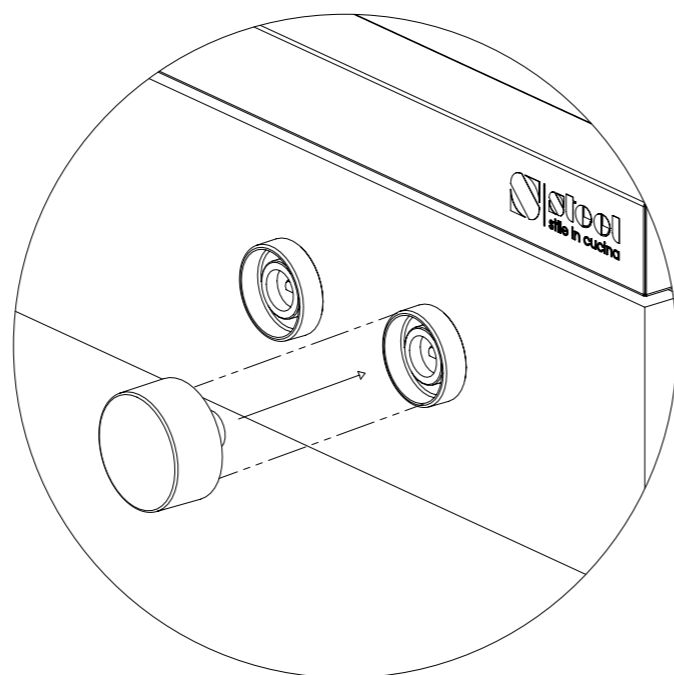

9.5

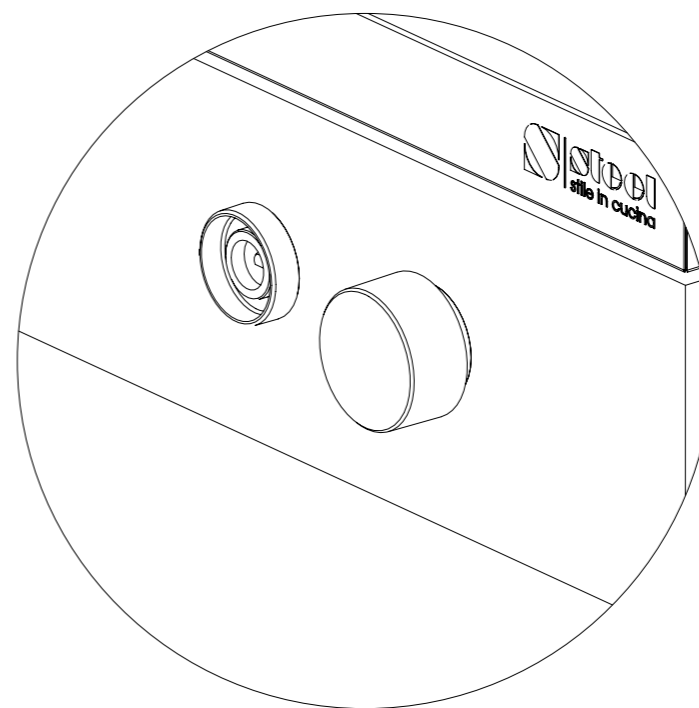



www.steel-cucine.com

STEEL SRL

Via dell'Agricoltura 21
41012 Carpi (MO) - Italy
T. + 39 059 645180
F. + 39 059 6220804
P. Iva 02593690361